

TANDEM 20 DOUBLE DRIVE



2-1/2 MILES OF HOSE

LARGE CAPACITY

The WER Tandem 20 is a high capacity hose coiler system capable of carrying 2-1/2 miles of lay flat hose. This uniquely versatile system consists of lead and trail units, which can be operated in unison from one tractor or independently as separate units.

**DIRECT DOUBLE
DRIVE SYSTEM**

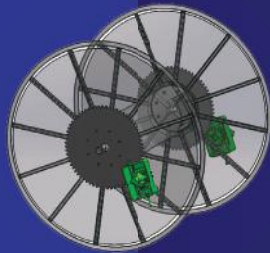

**88"
DIAMETER
REELS**

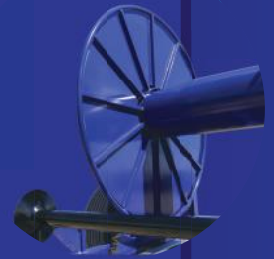

**OFFSET
TONGUE**



**10,000 LB
AXLES**

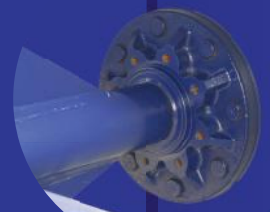

16 HOSE COILER DOUBLE DRIVE



2 MILES OF HOSE

HEAVY DUTY - LARGE CAPACITY

The WER 16 Hose Coiler comes standard with heavy duty frame and tandem walking beam axles. This Coiler utilizes a direct double drive system to increase power and reduce wear.

**DIRECT DOUBLE
DRIVE SYSTEM**

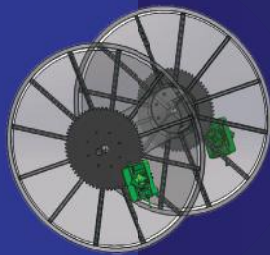

**102"
DIAMETER
REEL**



**OFFSET
TONGUE**

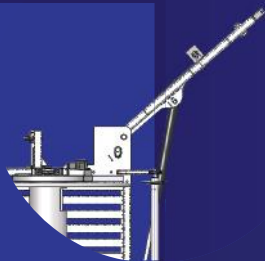

**10,000 LB
AXLES**

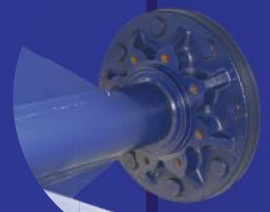

10 HOSE COILER DOUBLE DRIVE

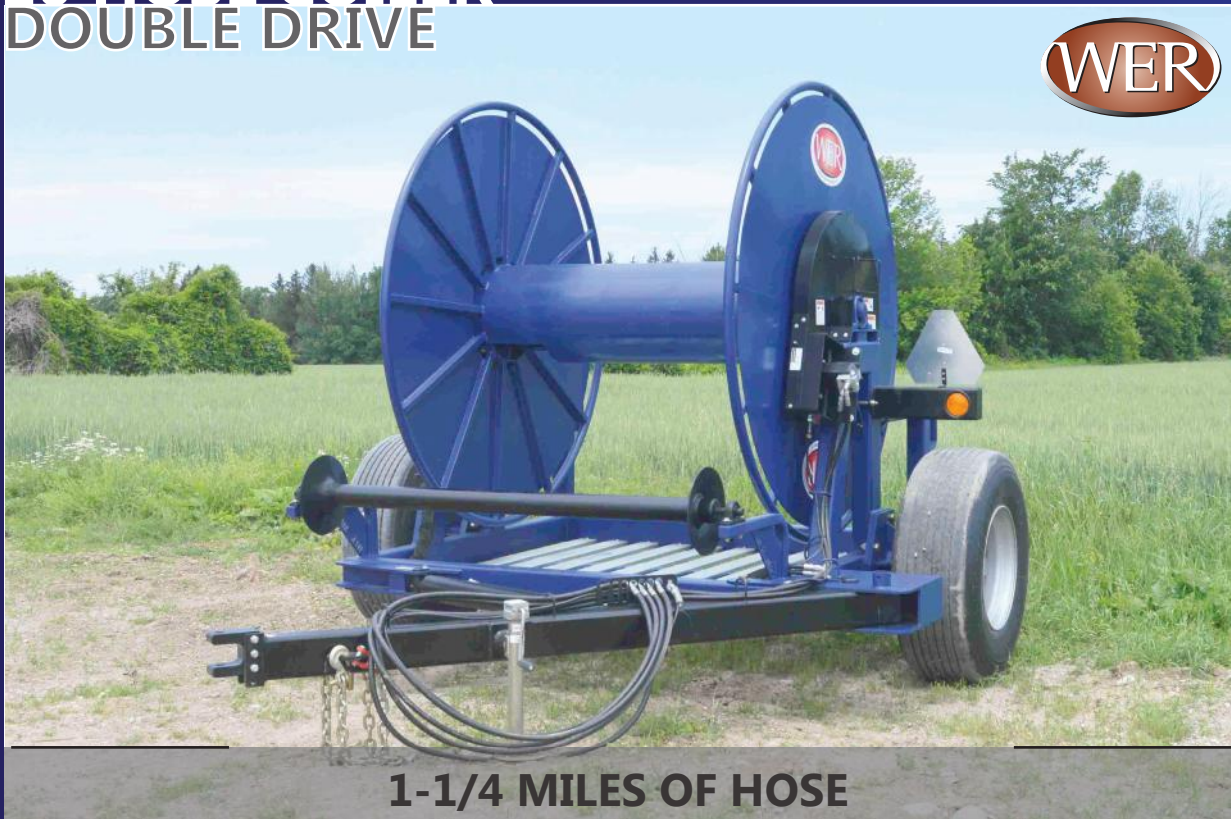

1-1/4 MILES OF HOSE

EFFICIENT & VERSATILE

The WER 10 Hose Coiler, is a single axle model, boasting a hydraulic double drive system, offset tongue, front roller, and a rear hitch, as standard features. Optional features include tail lights, tire upgrades, and a removable galvanized steel floor. Its simple operation make this an ideal fit for any drag line system.

**DIRECT DOUBLE
DRIVE SYSTEM**

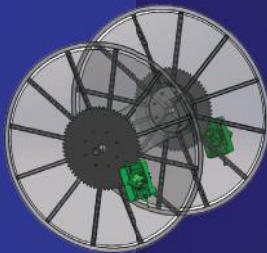

**88"
DIAMETER
REELS**



**OFFSET
TONGUE**



**10,000 LB
AXLES**

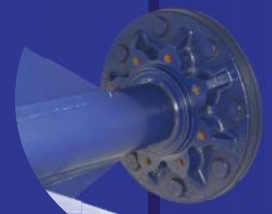

TPH HOSE COILER PROFESSIONAL DUTY



3/4 MILES OF HOSE

BUILT TO LAST

The WER Professional Duty TPH hose coiler will provide flexibility and durability, both as a stand-alone unit, or as an addition to a developing drag line system. Holds 6 x 6" hoses and is powered by a huge 630cc motor. Suits the front or rear TPH of the tractor.

ADJUSTABLE
LEGS



630CC
HYDRAULIC
MOTOR

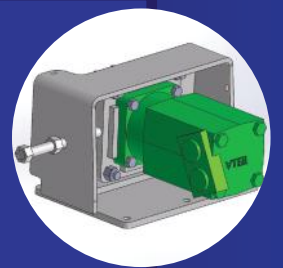

DIRECT
DRIVE

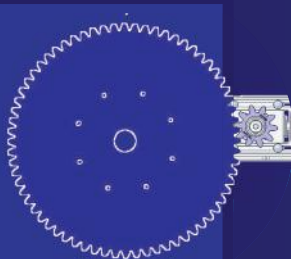

64"
DIAMETER
REEL



TPH COILER HEAVY DUTY

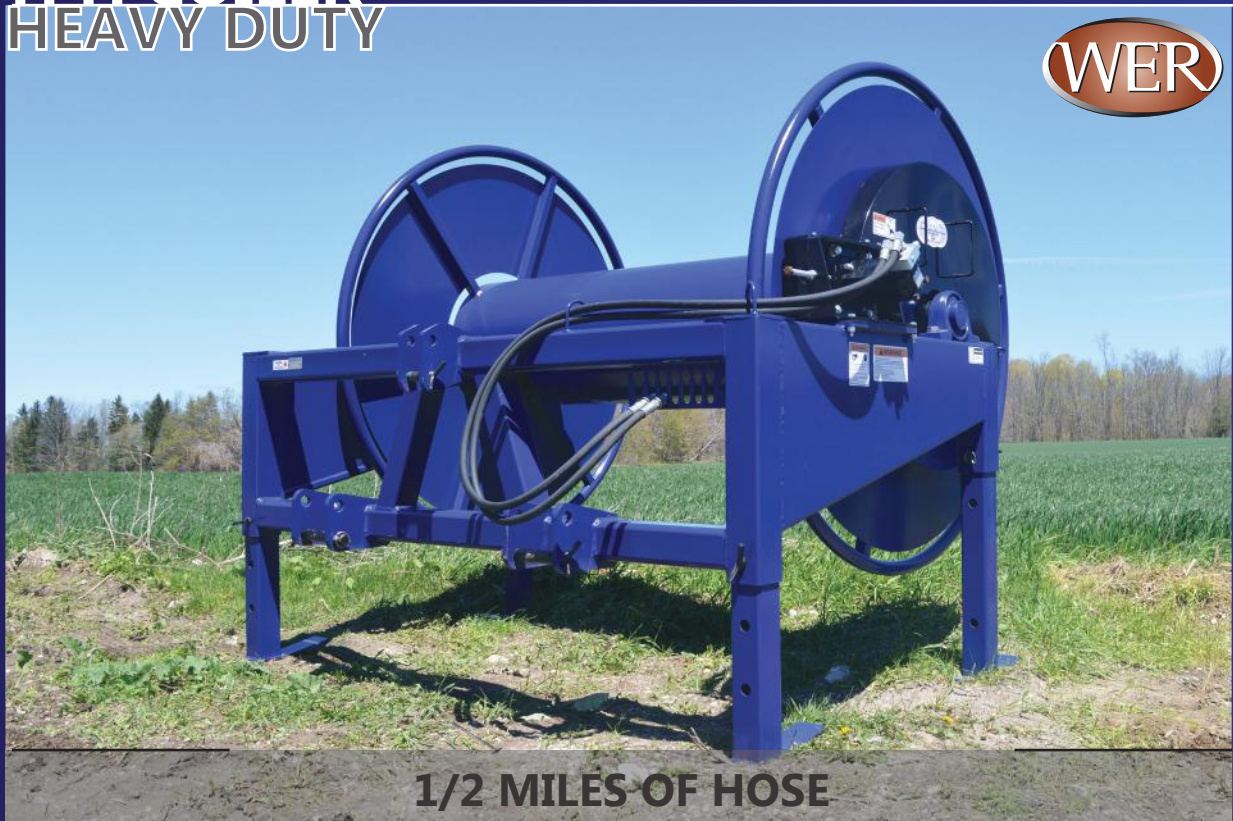

1/2 MILES OF HOSE

VERSATILE & RUGGED

With its additional features, the WER Heavy Duty 3 point hitch mount hose coiler will provide flexibility and durability, both as a stand-alone unit, or as an addition to a developing drag line system.

ADJUSTABLE
LEGS



400CC
HYDRAULIC
MOTOR

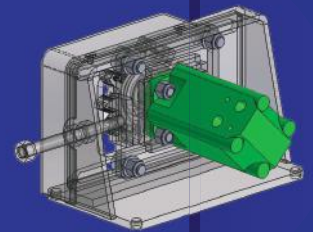

DIRECT
DRIVE

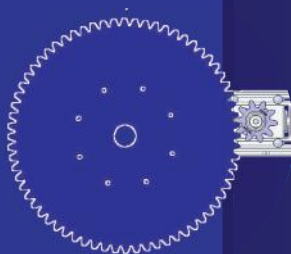

64"
DIAMETER
REEL



TPH COILER STANDARD DUTY



1/2 MILES OF HOSE

SIMPLE & RELIABLE

With its ease of operation, the WER Standard 3 point hitch mount hose coiler will provide excellent productivity, both as a stand-alone unit, or as an addition to a developing drag line system.

**64"
DIAMETER
REEL**



**315CC
HYDRAULIC
MOTOR**

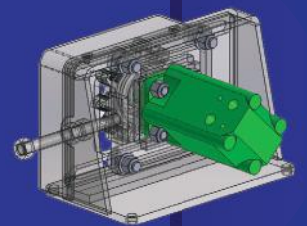

**DIRECT
DRIVE**

